

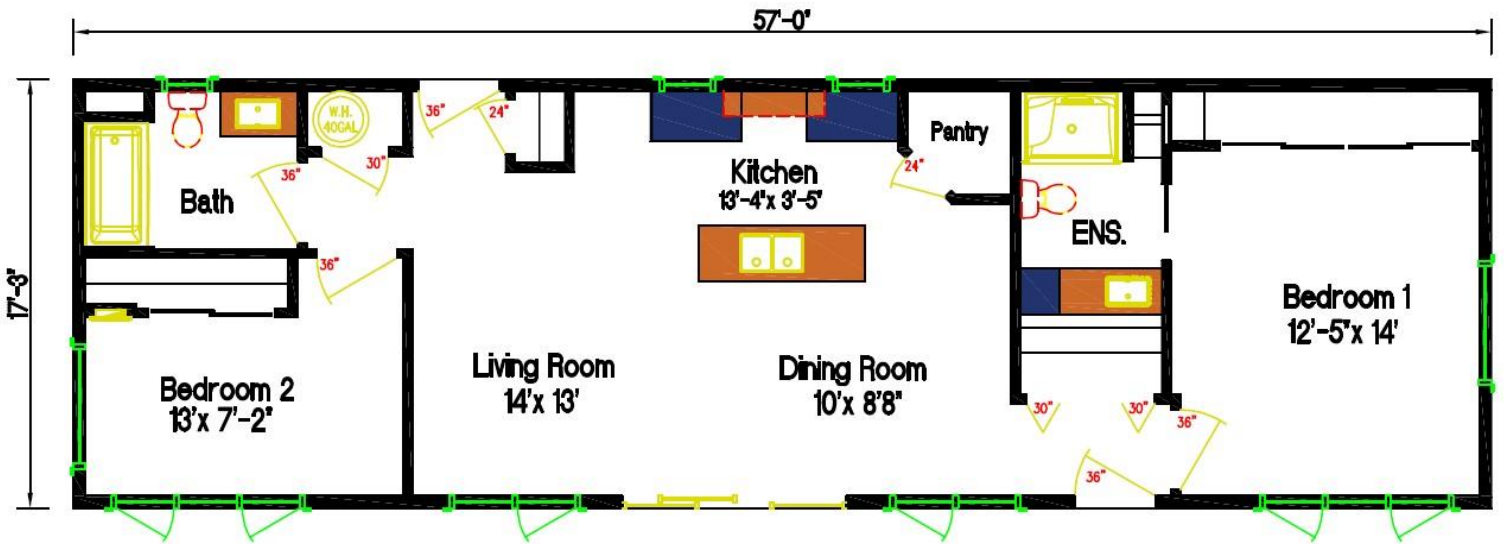

Maritime  
Homes Ltd.

10 Nova Scotia Trunk 10  
Cookville NS B4V 7P2  
902 527 2510  
[www.maritime-homes.ca](http://www.maritime-homes.ca)

Retreat 57 x 18



BUILT BY

MAPLE LEAF  HOMES



## Retreat 57 x 18

### HOME SPECIFICATIONS

This luxury 2-bedroom, 2-bathroom home has an open concept floor plan with a large living room and kitchen. This house also offers many comforts including large windows, upgraded bathrooms, and luxury exterior upgrades.

#### Interior:

- ✓ 4169 Laminate Floor
- ✓ Vinyl Plank Floors in baths
- ✓ 6 Stelpro Heater
- ✓ Painted Kitchen Cabinets
- ✓ Drawer Unit in Ensuite
- ✓ 72" island
- ✓ 24" Deep Cabinet above fridge
- ✓ Matte Black Cabinet Hardware
- ✓ Pull out recycle bins
- ✓ Subway Tile Back Splash
- ✓ Pots & Pans Drawers
- ✓ Linen Cabinet in Ensuite
- ✓ Rubix Tile in Main Bath
- ✓ 48" Alia Shower with Seat
- ✓ Main Bath Fixture
- ✓ 48" Shower Door
- ✓ Ensuite Shower Bar Faucet
- ✓ Main Tub Door
- ✓ BiFold W/D doors
- ✓ 23 LED Potlights
- ✓ 6 Extra USB receptacles
- ✓ 2 dimmer switches
- ✓ 5 LED lights in closets
- ✓ Corner Pantry
- ✓ Frosted Door in Pantry
- ✓ 16 Upgraded int doors
- ✓ Bypass door in closets
- ✓ MDF Shelving in ensuite
- ✓ MDF Shelving in Bed 1
- ✓ Square Edge Trim Package

- ✓ Lever Handles on All doors
- ✓ Single Pocket Door
- ✓ Whistler Quartz Countertops
- ✓ Kitchen Sink
- ✓ 2 Vanity sinks
- ✓ Kitchen Faucets
- ✓ Vanity Faucets
- ✓ Misc. Lights

#### Exterior:

- ✓ R24 Wall Insulation / R31 Floor Insulation / R50 Roof Insulation
- ✓ Skylight in Ensuite
- ✓ Board and Batten Siding
- ✓ PVC Corner Boards white
- ✓ PVC Facia Boards black
- ✓ Black Ext. Door Jambs
- ✓ Painted Front and Back Doors
- ✓ Full window on Front Door
- ✓ Full window on Rear Door
- ✓ Casement Window Package
- ✓ 2-3272-2 Window in Front
- ✓ 2-3272-3 Windows in Front
- ✓ 264" of Transom Windows
- ✓ 3 Panel Sliding Door
- ✓ 2 Matt Black Ext Handles
- ✓ Upgraded Coach Lights
- ✓ Metal Roof

BUILT BY

MAPLE LEAF  HOMES